

1 ROOF PLAN
SCALE: 1:100

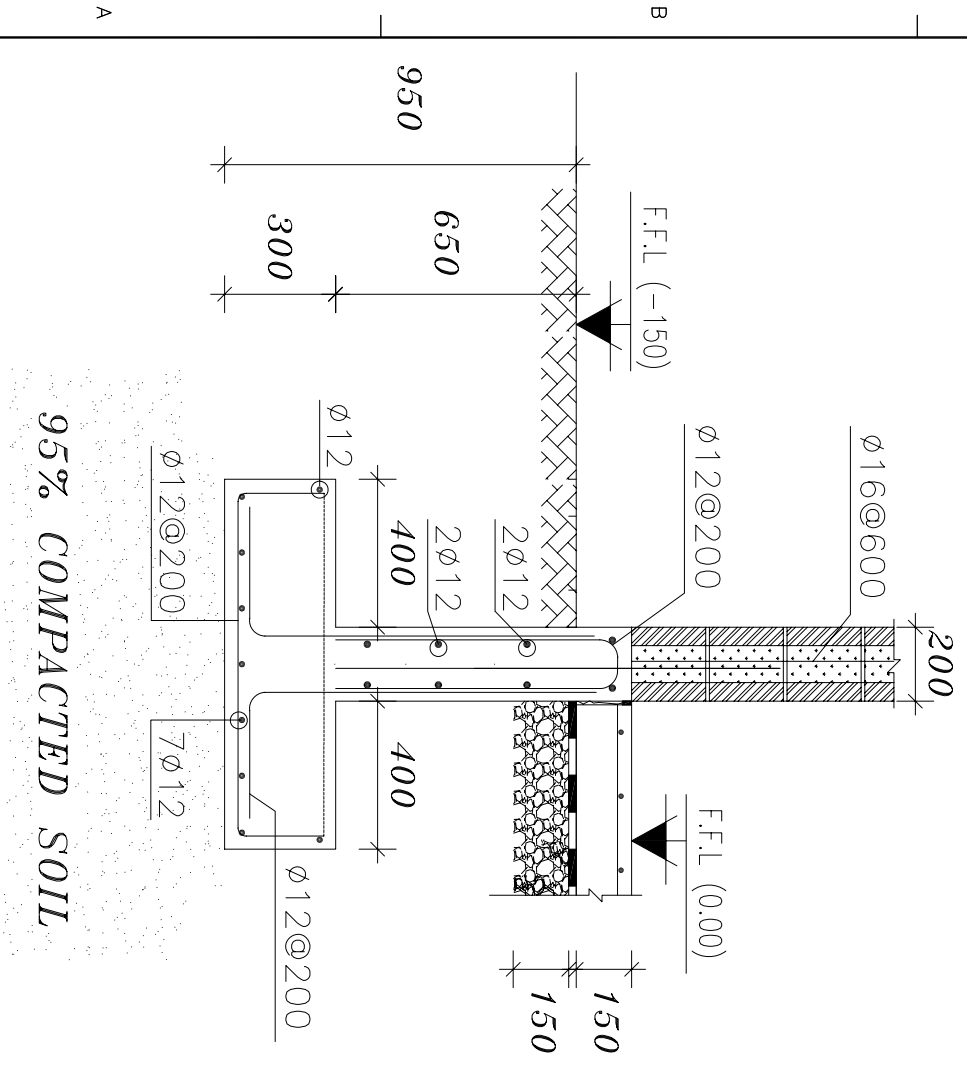

2 SECTION (1-1) F1
SCALE: 1:10

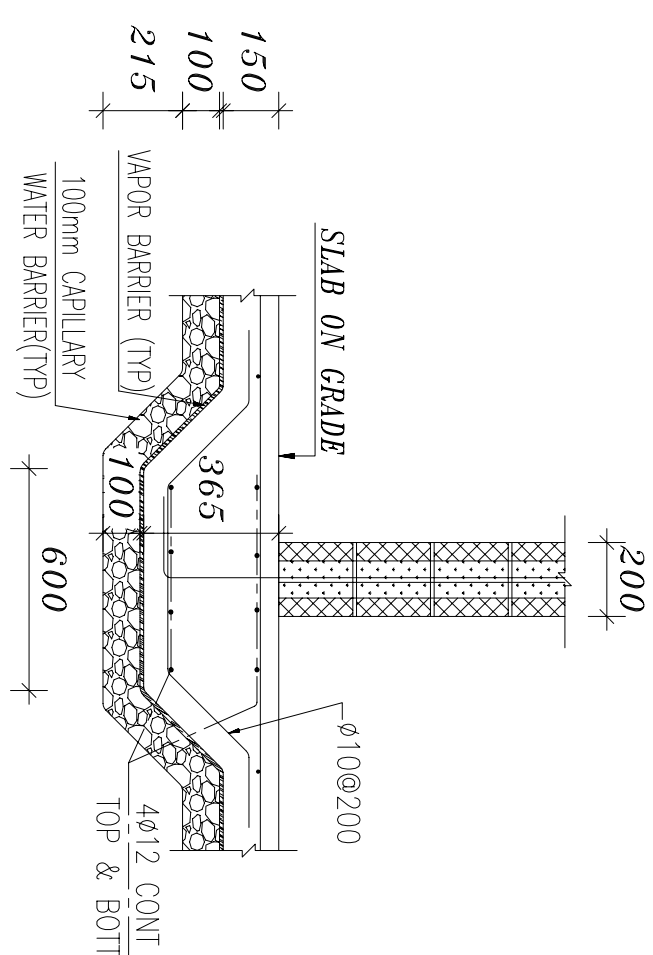

2 SLAB ON GRADE DETAIL
SCALE: 1:10

- Notes-**
- 1- FOOTING DESIGN IS BASED ON ASSUMED BEARING CAPACITY 0.8 KG/CM² AT FOUNDATION LEVEL 1.30m FROM THE FINISHED GRADE LEVEL. THESE ASSUMPTIONS SHOULD BE VERIFIED BY GEOTECHNICAL REPORT.
 - 2- ALL WORKS UNDER GROUND LEVEL HAVE TO BE COATED WITH BITUMINOUS LAYERS.
 - 3- SATISFACTORY MATERIALS SHALL COMPRISE ANY MATERIALS CLASSIFIED BY ASTM 22497 FOR BACKFILL.
 - 4- REINFORCED STEEL BARS ARE DEFORMED HIGH GRADE STEEL OF GRADE 60 (F_y=420 MPa).
 - 5- R.C CYLINDER MINIMUM STRENGTH = 20 MPa AFTER 28 DAYS.

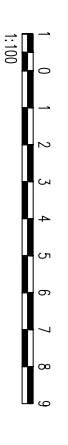

Sheet reference number:
B11-S-01

ANA COMMANDO COMPLEX
KABUL, AFGHANISTAN
KANDAK HHC SECTION BARRACKS
FOUNDATION PLAN AND DETAILS

Client:	US Army Corps of Engineers Afghanistan Engineer District Kobul Afghanistan	Designed by:	Drawn by:	Contract Date:
Contractor:	PRO SIMA	E.D.:	N.S.	File Name:
Designer:		Reviewed by:	Drwg. Code:	B11-S-01
		Submitted by:		Plot Date: 08/05/08
Solicitation No.:	W917PM-07-R-0034-0001			Plot Scale: 1:100&1:10
				Contract No.:
				W917PM-07-C-0034

Mark	Description	Date	Appr.	Mark	Description	Date	Appr.
ⓐ	65% DESIGN RESUBMITTAL#1	22/05/08					
ⓑ	65% DESIGN SUBMITTAL	06/03/08					
ⓒ	35% FINAL REVISED SUBMITTAL	19/01/08					
ⓓ	35% REVISED DESIGN SUBMITTAL	09/11/07					
ⓔ	35% DESIGN SUBMITTAL	17/09/07					

U.S. ARMY CORPS OF ENGINEERS
AFGHANISTAN
ENGINEER DISTRICT